



Let's try to build the fastest Thymio in the world!

✓ Any wheels or LEGO parts are OK!



Thymio



LEGO



Big Wheels

✗ Don't use other engines, motors, or vehicles to push or pull Thymio!



Mission

- Build a Thymio-powered racer using LEGO gears, bigger wheels, or any other techniques.
- Find the speed of your fastest Thymio-powered racer by measuring the distance after moving for 6 seconds on flat ground.

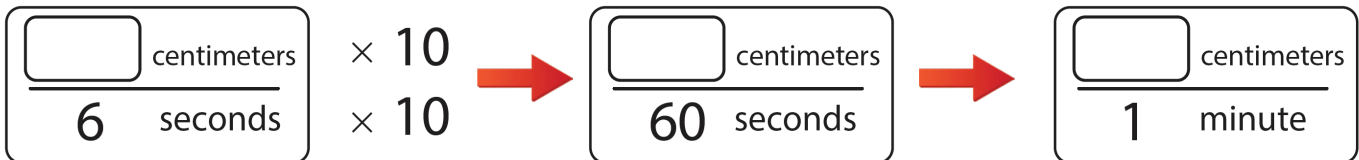
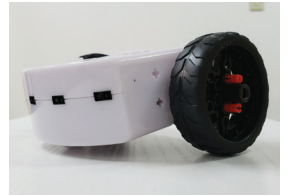

- Try to improve your racer until you find the fastest speed!

Hints

- Bigger wheels make Thymio go faster.
- A big gear turning with a small gear will turn the small gear faster.

My fastest speed is

<input type="text"/>	centimeters
<hr/>	
1	minute

Don't forget to take pictures and videos to share!

 **Share your work!**





Ideas to build the fastest Thymio in the world!

Solution Idea 1 - Super Big Plate Wheels

These big wheels are sure to make Thymio super fast!

1. Get two plastic discs, cardboard circles, or other light round materials like plastic plates.
2. Drill holes in the discs.
3. Screw two large gears onto each side of the discs.
4. Attach the discs to Thymio's wheels.

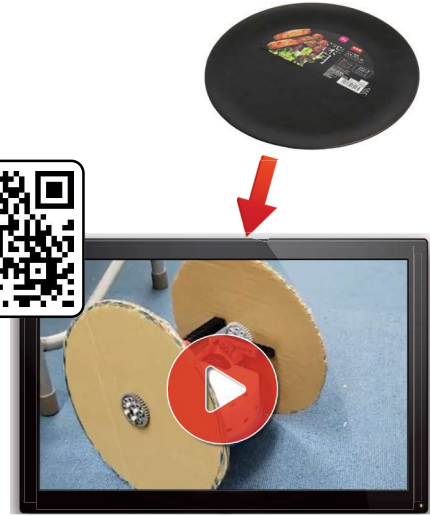

Solution Idea 2 - Fast Gears with LinkVest

Using LinkVest, you can easily connect gears to make Thymio go even faster. There are many ways to connect gears, but which way is the fastest? Watch this video to see one cool way to do it.



Now it's your turn to try again!

These two ideas will make Thymio faster, but are they the fastest in the world? Maybe your next Thymio build will set the new world record. Good luck!

My fastest speed is

<input type="text"/>	centimeters
<hr/>	
1	minute

Don't forget to take pictures and videos to share!

Share your work!

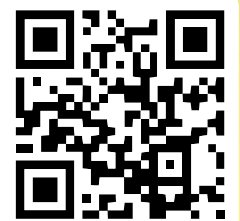

Fastest Thymio